

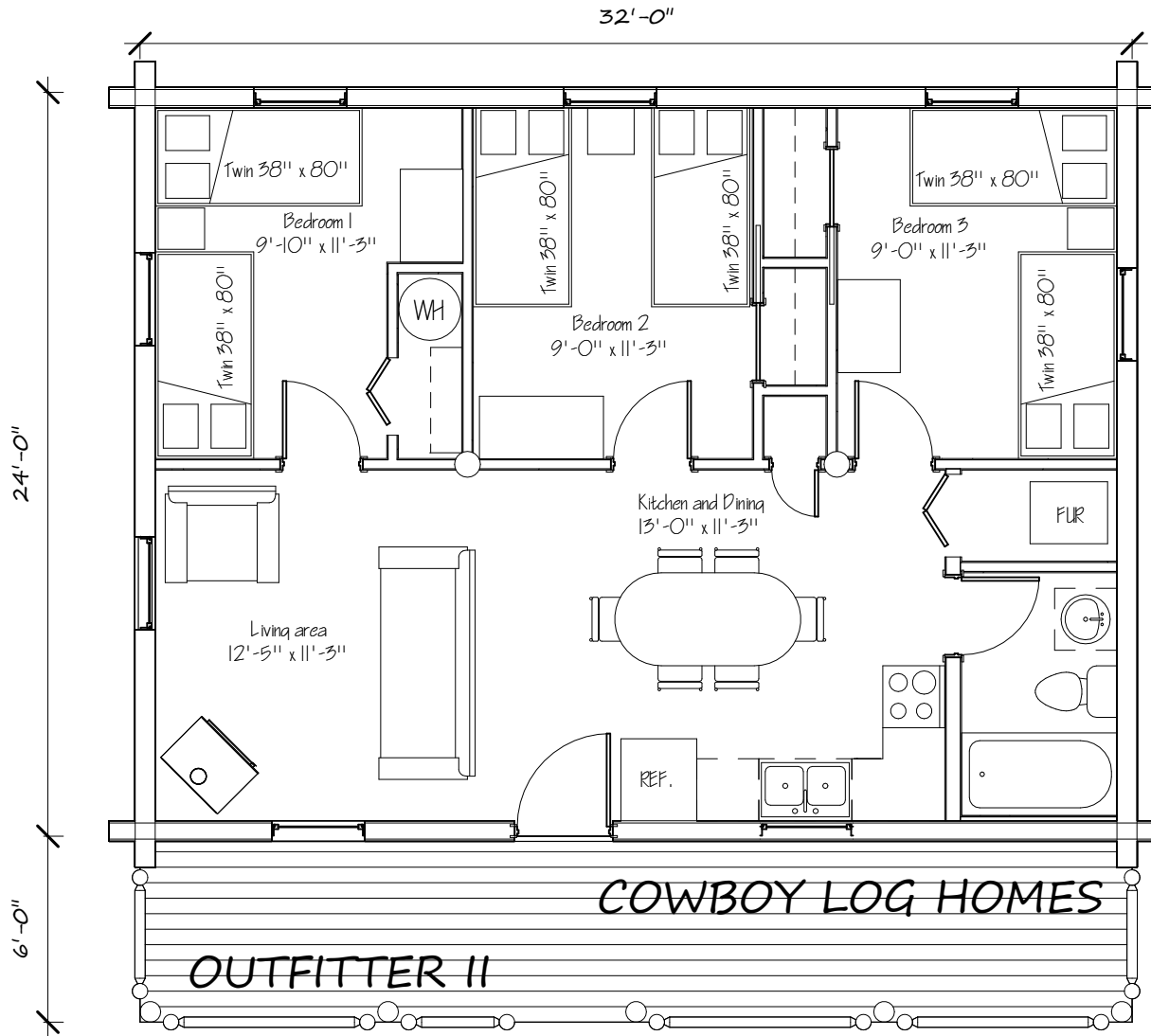

*OUTFITTER II*

Email: [mike@cowboyloghomes.com](mailto:mike@cowboyloghomes.com) Phone: (406)388-3458 1



AREAS	
DECK	192 SF
FIRST FLOOR	768 SF



OUTFITTER II

## SWEDISH COPE LOG SHELL

WINDOW SILL LOGS, DOOR & WINDOW HEADER LOGS,  
GABLE ENDS, LOG POSTS, LOG BEAMS, ELECTRICAL OPENINGS,  
INTERIOR WALL LOCATIONS REQUIRE FIELD CUTTING.

- \* LAG SCREWS FOR POST & BEAM CONNECTIONS
- \* LAG SCREWS FOR FIRST LOG ROW
- \* ONLY LOG SCREWS
- \* 1" WOOD DOWELS FOR END JOINTS
- \* 2 ROWS OF FOAM TAPE PER LOG COURSE
- \* LOG BUILDERS CAULK
- \* SCREW SETTLE JACKS
- \* ALL LOGS NUMBERED FOR ASSEMBLY
- \* LOG SCHEDULE
- \* CONSTRUCTION
- \* DELIVERY TO JOB SITE 1,000 MILES F.O.B.  
BELGRADE, MT.

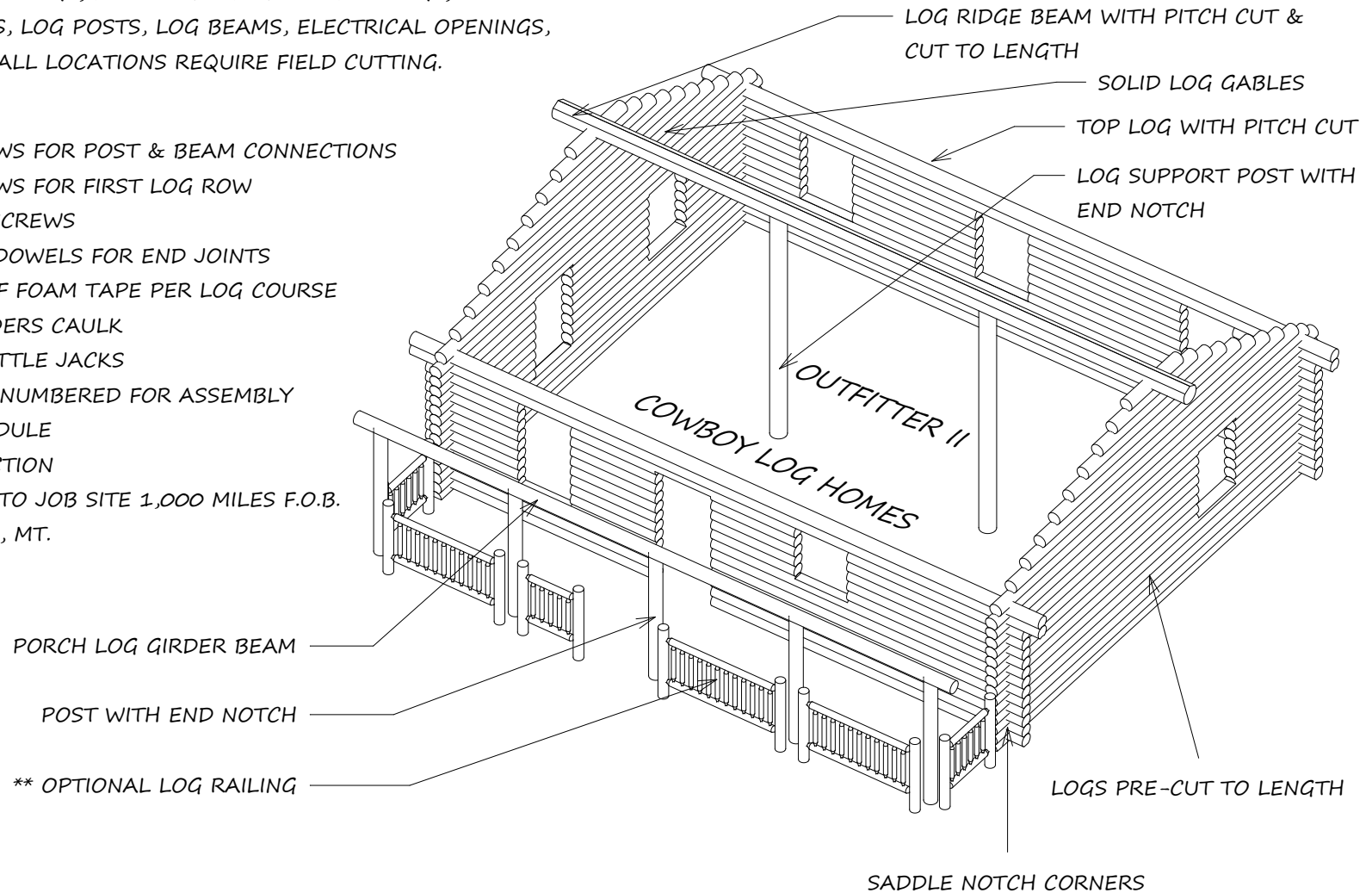

OUTFITTER II

Email: [mike@cowboyloghomes.com](mailto:mike@cowboyloghomes.com) Phone: (406)388-3458 3

#### DRY IN MATERIALS INCLUDED

- ~ First floor framing & sheathing(2"x10" floor joists)
- ~ Treated sill plate and foam sill seal
- ~ Girder beam and support posts
- ~ Deck framing with joist hangers
- ~ 5/4" Decking
- ~ Interior wall framing
- ~ Door and window bucks
- ~ Main roof framing 2" x 12" DF #2
- ~ Porch roof framing 2" x 6" DF #2
- ~ Roof sheathing 15" x 32" Plywood
- ~ Roofing underlayment
- ~ Exterior 1x pine trim
- ~ Pine fascia
- ~ Pine 1x6 T&G soffit
- ~ Exterior door allowance
- ~ Window allowance

#### Materials not included

- ~ Nails, screws, caulking, liquid nail, treated post, stain, paint, concrete foundation, and finished roofing.

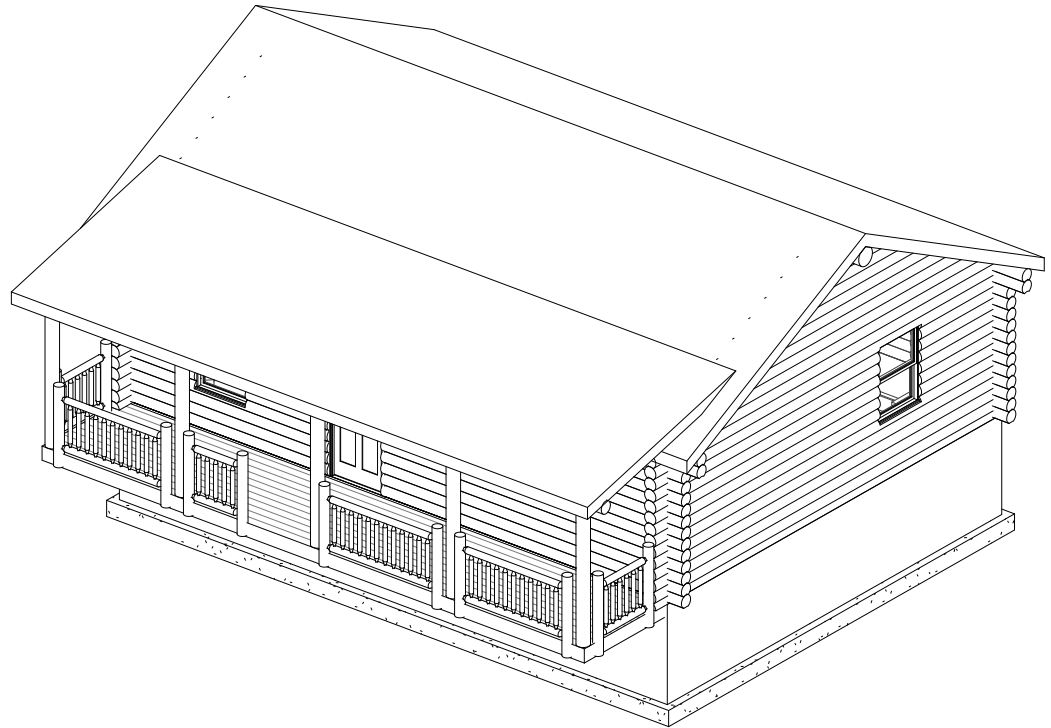

OUTFITTER II

Email: [mike@cowboyloghomes.com](mailto:mike@cowboyloghomes.com) Phone: (406)388-3458 4