

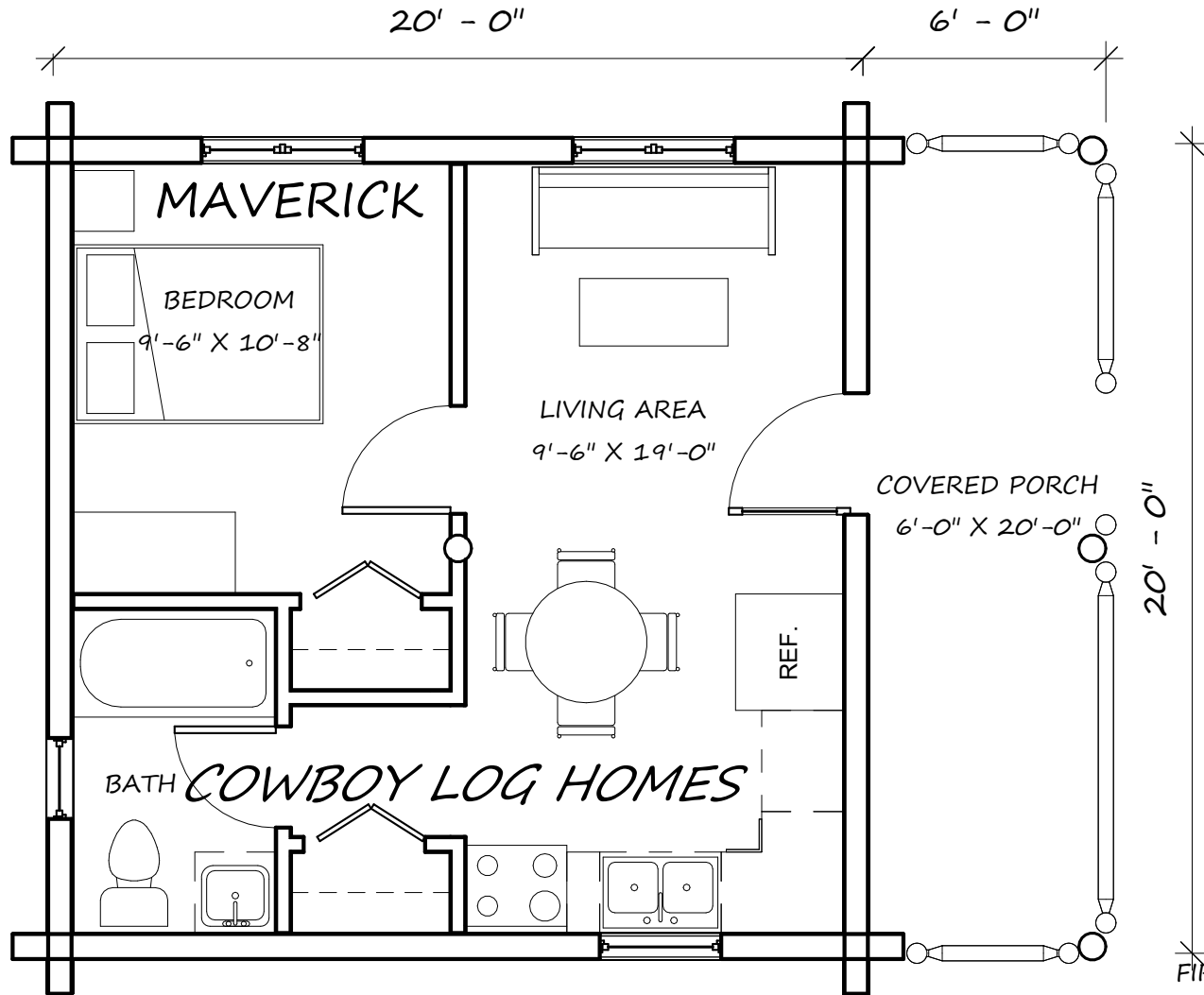

THE MAVERICK

Email: mike@cowboyloghomes.com

Phone: (406)388-3458



FIRST FLOOR 400 SQ. FT.
PORCH 120 SQ. FT.



THE MAVERICK

SWEDISH COPE LOG SHELL PACKAGE

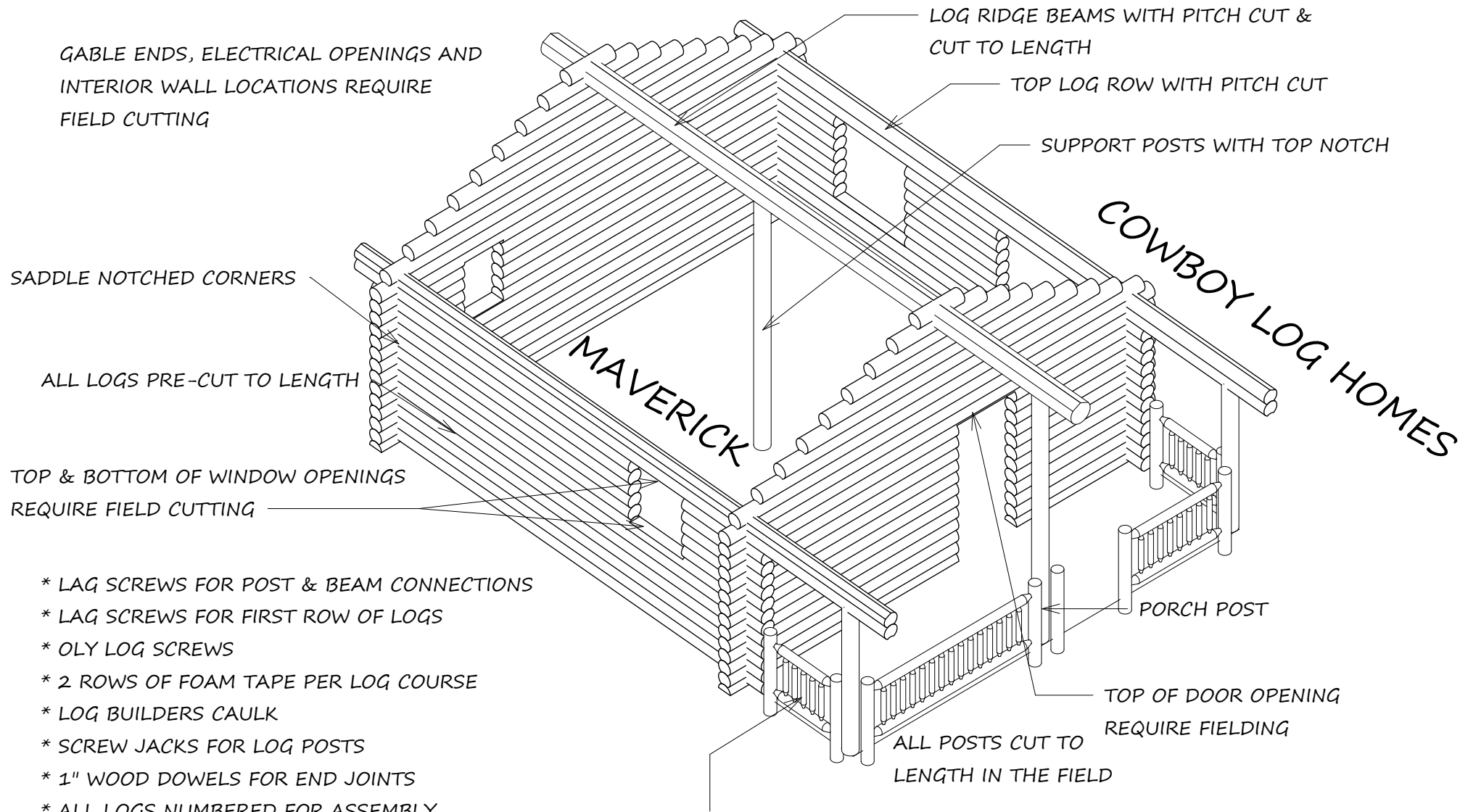

GABLE ENDS, ELECTRICAL OPENINGS AND INTERIOR WALL LOCATIONS REQUIRE FIELD CUTTING

SADDLE NOTCHED CORNERS

ALL LOGS PRE-CUT TO LENGTH

TOP & BOTTOM OF WINDOW OPENINGS REQUIRE FIELD CUTTING

- * LAG SCREWS FOR POST & BEAM CONNECTIONS
- * LAG SCREWS FOR FIRST ROW OF LOGS
- * ONLY LOG SCREWS
- * 2 ROWS OF FOAM TAPE PER LOG COURSE
- * LOG BUILDERS CAULK
- * SCREW JACKS FOR LOG POSTS
- * 1" WOOD DOWELS FOR END JOINTS
- * ALL LOGS NUMBERED FOR ASSEMBLY
- * LOG SCHEDULE
- * CONSTRUCTION DRAWINGS
- * DELIVERY TO JOB SITE 1,000 MILES F.O.B. FROM BELGRADE, MT

** OPTIONAL LOG RAILING



THE MAVERICK

Email: mike@cowboyloghomes.com

Phone: (406)388-3458

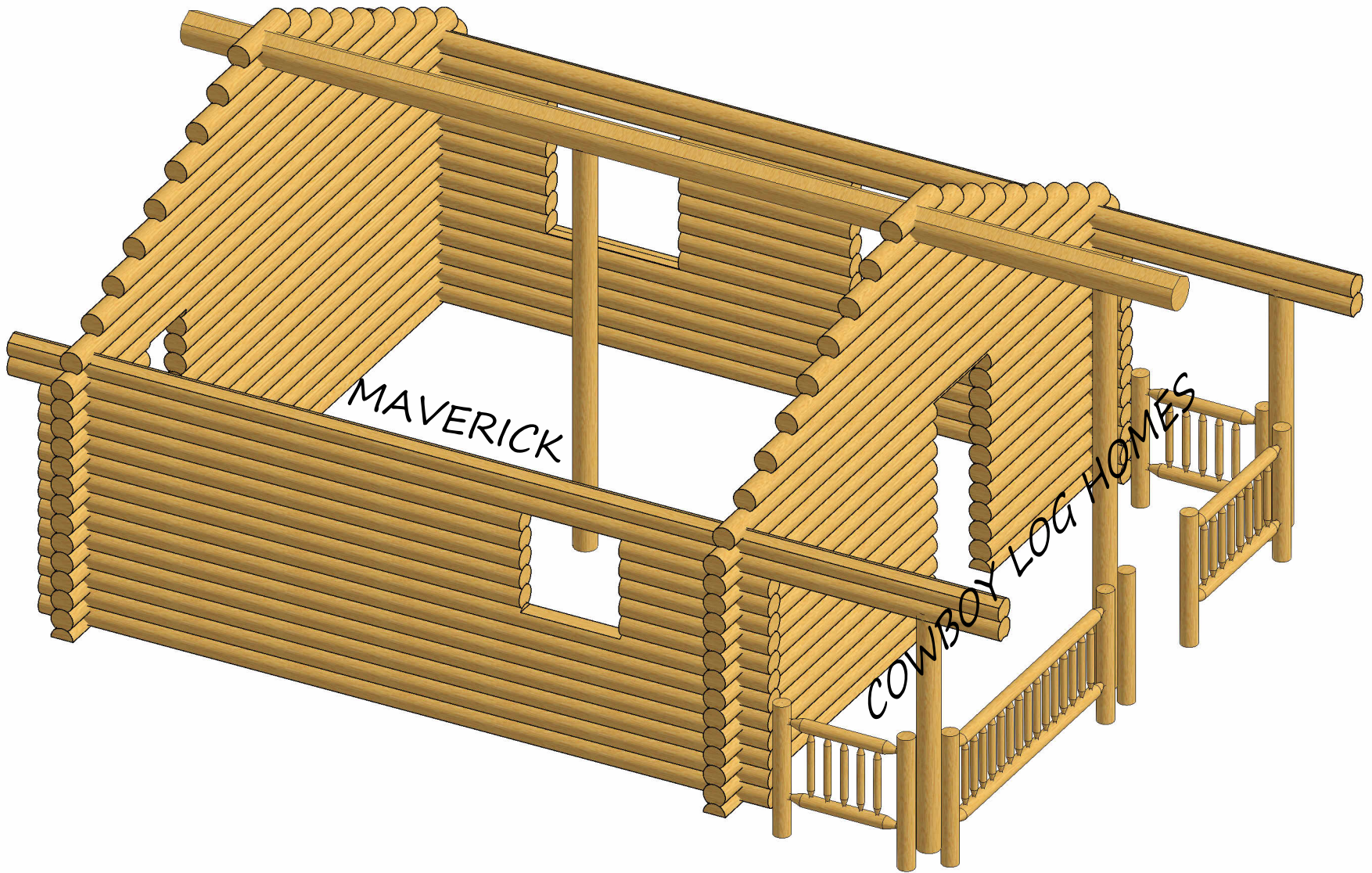

MAVERICK

COWBOY LOG HOMES



THE MAVERICK

Email: mike@cowboyloghomes.com

Phone: (406)388-3458